

Schottenpomp 1PAK

Pompes à piston

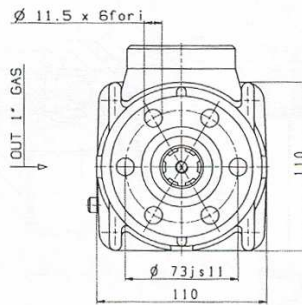
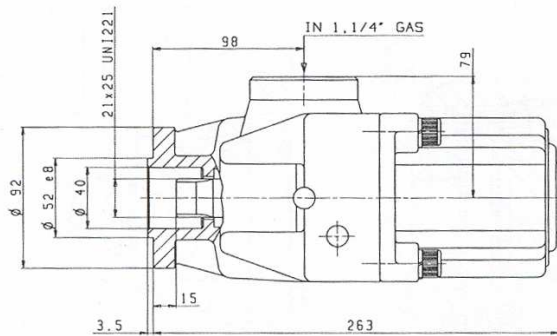

1 PAK Typ 3F

1 PAK Typ ISO

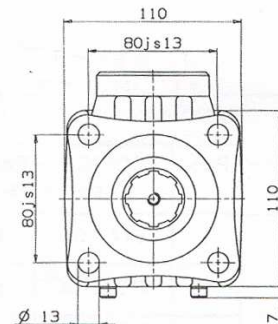
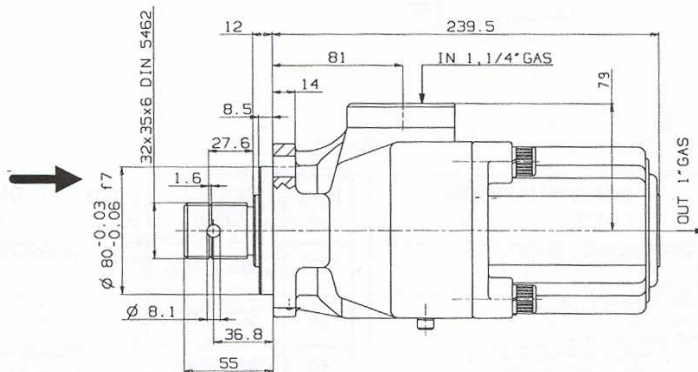

Type	Volume cm ³ /U	Max. bar	Max. T/min	kg	Zuigzijde	Drukzijde	Ref.
					Aspiration BSP	Pression BSP	
1 PAK-21-3F	20,25	350	1800	12,1	1 1/4"	1"	*
1 PAK-21-I	20,25	350	1800	12,8	1 1/4"	1"	*
1 PAK-28-3F	27	350	1800	12,0	1 1/4"	1"	*
1 PAK-28-I	27	350	1800	12,9	1 1/4"	1"	8054295
1 PAK-35-3F	33,75	350	1800	10,8	1 1/4"	1"	*
1 PAK-35-I	33,75	350	1800	11,1	1 1/4"	1"	*
1 PAK-42-3F	40,5	350	1800	10,7	1 1/4"	1"	*
1 PAK-42-I	40,5	350	1800	11,0	1 1/4"	1"	*
1 PAK-48-3F	47,25	350	1800	10,7	1 1/4"	1"	*
1 PAK-48-I	47,25	350	1800	11,0	1 1/4"	1"	8054297
1 PAK-55-3F	54	350	1800	10,2	1 1/4"	1"	*
1 PAK-55-I	54	350	1800	11,1	1 1/4"	1"	*
1 PAK-60-3F	59,3	300- 350	1500	11,9	1 1/4"	1"	*
1 PAK-60-I	59,3	300- 350	1500	12,3	1 1/4"	1"	8054298

Dichtingsset / Kit de joints 1 PAK		*
------------------------------------	--	---

Aansluiting / Filetages:
 3F = 3F Flens / Bride
 I = ISO Flens / Bride

Draairichting / Rotation
 D = Rechts / Droite
 S = Links / Gauche

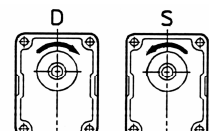

* : Leverbaar op aanvraag
 * : Disponible sur demande

Schottenpomp 2PAK Pompes à piston 2PAK

2 PAK Typ ISO

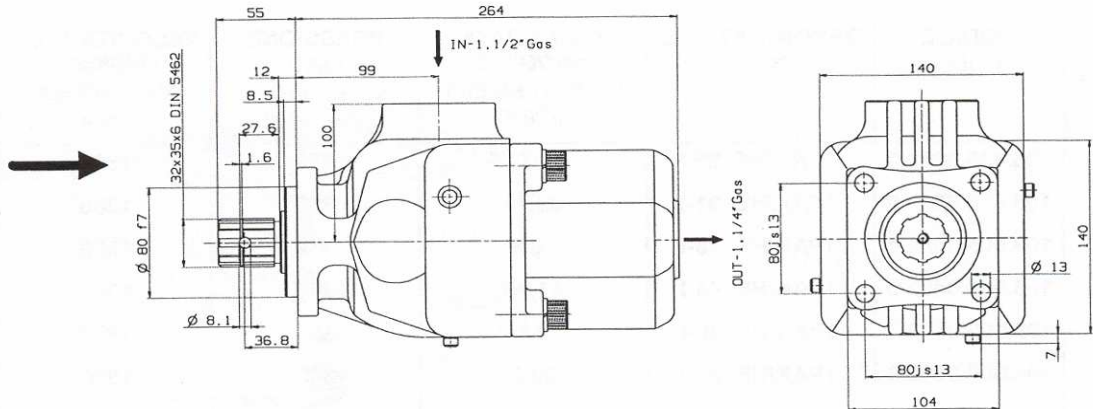

Type	Volume cm ³ /T	Max. bar	Max. T/min	kg	Zuigzijde	Drukzijde	Ref.
					Suction	Pression	
2 PAK-70-I	73	300- 350	1500	20,9	BSP 1 1/2"	BSP 1 1/4"	*
2 PAK-80-I	82,2	300- 350	1500	20,3	1 1/2"	1 1/4"	8054299
2 PAK-90-I	91,4	300- 350	1500	20,2	1 1/2"	1 1/4"	*
2 PAK-100-I	1004	300- 350	1500	20,0	1 1/2"	1 1/4"	8054300

Dichtingsset / Kit de joints 2 PAK		*
------------------------------------	--	---

Aansluiting / Filetages:

3F = 3F Flens / Bride

I = ISO Flens / Bride

Draairichting / Rotation

D = Rechts / Droite

S = Links / Gauche

* : Leverbaar op aanvraag

* : Disponible sur demande

